

LEXI 52" LED CEILING FAN SN

Specifications

Material Construction:	Steel motor housing, mixed steel, copper and other materials for motor parts
Motor Size:	153mm Dia x 18mm H
Diameter:	52" diameter
Downrod:	3/4" dia. X 6" long
Mounting:	Dual-mount adaptable (downrod & vaulted ceiling)
Blade Details:	5 blades; not reversible
Blade Color:	Black
Blade Material:	ABS
Speed Control:	3 speed pull chain control
Voltage:	120V
Weight:	19 lbs.
Light Kit - Lens	Frosted glass
Light Kit - Lamp Info	2 x 7W,E-12 based LED Bulbs; included
Lumens:	970 Lumens
CCT:	2700K
CRI:	80
Airflow at High Speed:	5600CFM
Electricity Usage:	59W
Airflow Efficiency:	94CFM/W



Dimensions

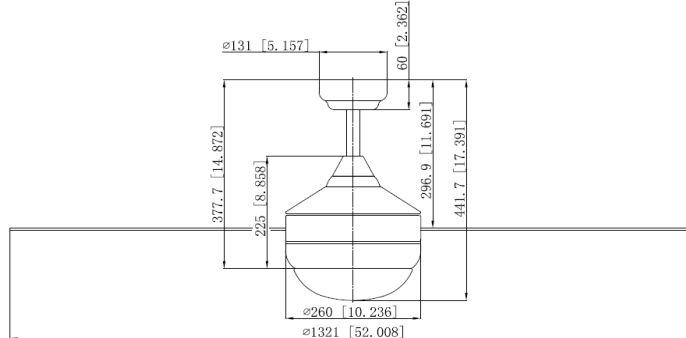

Warranty & Compliances

Warranty	10 Year Limited Warranty
UL/ETL Listing	ETL



Order Codes

Description

LEXI 52" LED
CEILING FAN SN

Order Code
154344

Type:
Job:
Order Code:
Approvals:

Design House reserves the right to make changes in materials, specifications & models at any time. Design House also reserves the right to discontinue product without notice or obligation.