



FLUSH MOUNT FIXTURE ASSEMBLY/INSTALLATION INSTRUCTIONS

Please read carefully and save these instructions, as you may need them at a later date.

CAUTION

WARNING: Risk of Fire. Min 90°C supply conductors. Consult a qualified electrician to ensure correct branch circuit conductor.

Turn off the main power at the circuit breaker before installing the fixture, in order to prevent possible shock.

GENERAL

All electrical connections must be in accordance with local and National Electrical Code (N.E.C.) standards. If you are unfamiliar with proper electrical wiring connections obtain the services of a qualified electrician.

Remove the fixture and the mounting package from the box and make sure that no parts are missing by referencing the illustrations on the installation instructions.

ASSEMBLY AND INSTALLATION

- Before installing, preset the NIPPLE (16) length:
 - Thread the HEX NUT (14) onto the NIPPLE (16), and screw the NIPPLE (16) into the BUSHING (15) on the FIXTURE PAN (12) a minimum of four turns.
 - Place the center holes of the GLASS SHADE (17) over the NIPPLE (16) and adjust the NIPPLE (16) so that it protrudes out of the GLASS SHADE (17) or CAP (19) about 1/4". Remove the GLASS SHADE (17) and secure the NIPPLE (16) in place by tightening the HEX NUT (14).
- Pull the SUPPLY WIRES (5 & 6) and GROUND WIRE (7) out from the OUTLET BOX (1) and attach the CROSSBAR (2) to the OUTLET BOX (1) using the slotted holes on the CROSSBAR (2) and the MOUNTING SCREWS (3) provided.
- Thread the FIXTURE SCREWS (4) two full turns into the appropriate threaded holes in the CROSSBAR (2). (Check the CROSSBAR (2) against the fixture KEY HOLE SLOTS (13) to ensure proper fit.)
- Make the wiring connection: Connect the FIXTURE GROUND WIRE (10) to the SUPPLY GROUND WIRE (7) with a WIRE CONNECTOR (11) (not included) and then attach them to the CROSSBAR with GREEN GROUND SCREW (20). Connect the BLACK SUPPLY WIRE (6) to the BLACK FIXTURE WIRE (9) and WHITE SUPPLY WIRE (5) to the WHITE FIXTURE WIRE (8) with WIRE CONNECTORS (11).

ASSEMBLY AND INSTALLATION (CONT.)

- Carefully tuck all wiring back into the OUTLET BOX (1). Locate the FIXTURE PAN (12) over the OUTLET BOX (1), positioning the FIXTURE SCREWS (4) heads through the large openings of the KEY HOLE SLOTS (13). Rotate the FIXTURE PAN (12) to seat the screws, and tighten securely. (See Fig. 2)
- Install the bulbs (Sold separately). See markings and/or labels on the fixture for maximum wattages ,DO NOT EXCEED THE MAXIMUM WATTAGE!
- Place the center hole of the GLASS SHADE (17) over the NIPPLE (16) and secure the GLASS SHADE (17) with the FINIAL KNOB (18) (See Figure 1) or secure the GLASS SHADE (17) and CAP (19) with the FINIAL KNOB (18) (See Fig . 3).

NOTE: For safe installation, you can also secure the GLASS SHADE (17) with one HEXNUT first and then locate the FINIAL KNOB (18) or CAP (19) and FINIAL KNOB (18)

- INSTALLATION IS NOW COMPLETE. Restore electric power to fixture.

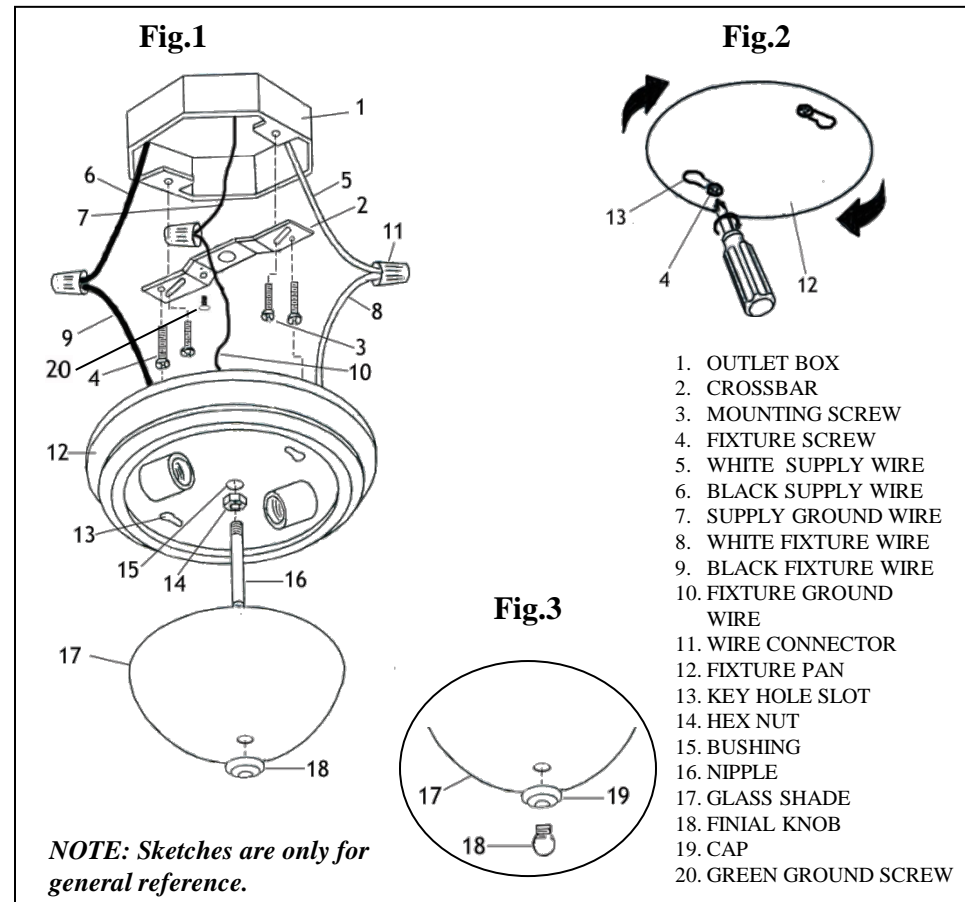

Customer Service 1-800-558-8700