

PRODUCT COMPONENT INSTRUCTION

829127 / 829143 / 829135
KENTON PULLDOWN KITCHEN FAUCET

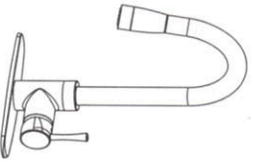

DIMENSIONS

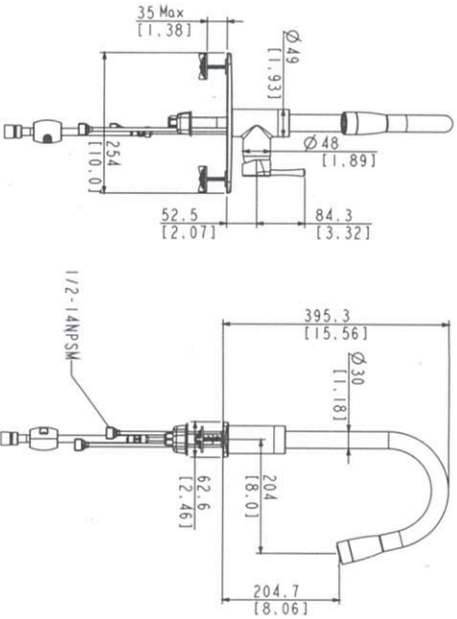

■ For Reference only (unit = mm[inch])

FAUCET MAINTENANCE

Please read the followings before installing and usage.

1 Installation

Rinse the inlet pipe clean.
 Exactly connect to appropriate water supplies with hot water supply on the left side and cold on the right side.

2 Technique Parameter

Water Pressure: 0.1MPa-0.86MPa.
 Water Temperature: 5-71°C.

3 Surface maintenance

Remove as mush surface dirt and film using clear water and cotton cloth.
 Spray cleaner such as mild liquid detergents, clearliquid glass cleaner, non-acidic and fully dissolved powder cleaners or non-abrasive liquid polishers on the rag to clean the faucet surface.
 Once clean,rinse faucet again with clear water to thoroughly remove cleaner and dry with soft cotton cloth.

EXPLODED DRAWING

Please read the followings before installing and usage.

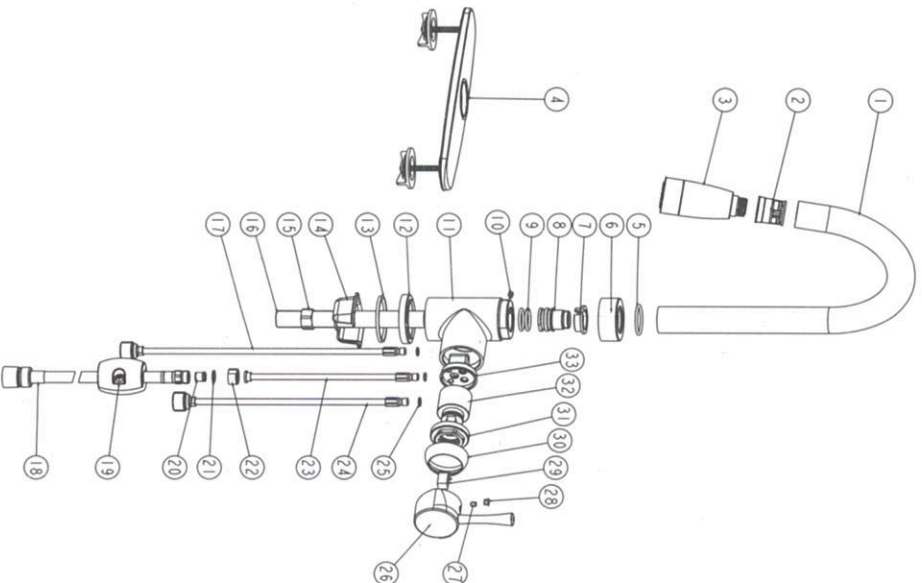

NO.	Part No	Qty
01	ATBP0247	1
02	CTCP0375	1
03	ATBE0124	1
04	ATBQ0295	1
05	CTRR0218	1
06	CTCZ0178	1
07	CTRP0051	1
08	CTMB0298	1
09	CTRR0013	2
10	CTST0059	1
11	CTYZ0012	1
12	CTDZ0074	1
13	CTWR0114	1
14	CTLT0020	1
15	CTNB0276	1
16	CTPB0498	1
17	ATBP1008	1
18	ATBP0251	1
19	ATBQ0313	1
20	ATBA0100	1
21	CTWR0037	1
22	CTNB0277	1
23	ATBP0252	1
24	ATBP1009	1
25	CTRR0182	3
26	CTHZ0461	1
27	CTST0117	1
28	CTCP0072	1
29	CTKP0020	1
30	CTCB0185	1
31	CTKB0058	1
32	ATBA0121	1
33	CTDN0023	1

■ Notes: For reference only. We reserve the right to make changes without any notice.



MULTIHOUSING DIRECT

GENERAL INSTALLATION INSTRUCTIONS

Notes: These installation instructions are for all types of faucets, the faucet in this instructions is for reference only.

KITCHEN FAUCET KITCHEN FAUCET WITH SIDESPRAYER

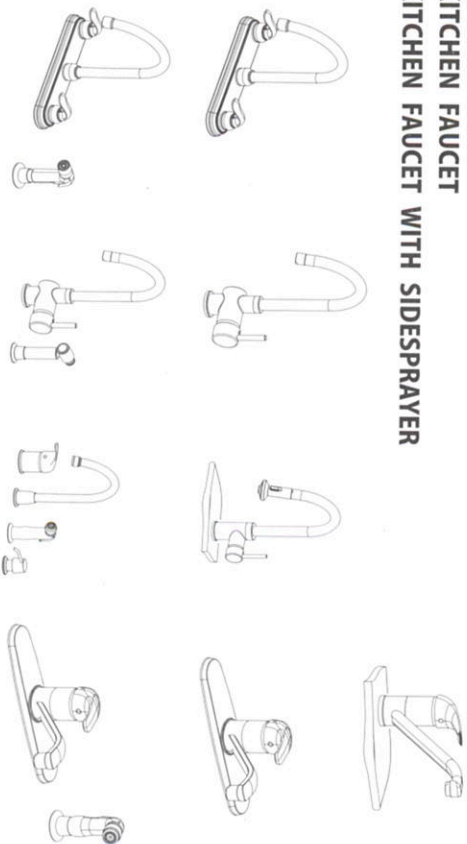

BEFORE INSTALLATION

- ▶ Please read these instructions carefully before starting the installation to avoid any unnecessary damage.
- ▶ Please check if the product is in a good condition after opening the package. The recommended tools shall be provided by yourself and not included with this product.
- ▶ All information is based on the latest product information available at the time of publication. We reserve the right to make changes in product characteristics, packaging or availability at anytime without notice.
- ▶ Please keep these instructions after installation for reference.
- ▶ All illustration and dimensions provided by these instructions are only for reference. For the installation, please refer to the actual product.
- ▶ Before installing and using this product, user shall carefully read and understand the content of these instructions.

RECOMMENDED TOOLS AND MATERIALS



Pipe Sealing Tape

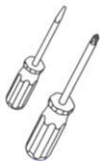

Flathead Screwdriver,
Phillips Screwdriver



Tape Measure



Adjustable Wrench



Hex Wrench



Pipe Wrench

ATTENTIONS

- Please read the followings before installing and usage.
- ▶ To avoid blockage, please flush all pipes before installing new fixture.
 - ▶ Connect to appropriate water supplies with hot water supply on the left side and cold on the right side.
 - ▶ For proper installation, verify the installation dimensions against the fixture.
 - ▶ The temperature of the hot water shall not be higher than 71°C.

INSTALLATION

Please read the followings before installing and usage.

■ For Reference only (unit = mm)



Notes: If the faucet you bought has no sprayer, drill the hole 1 will be ok.

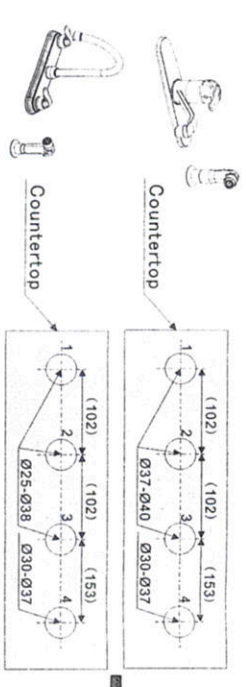

Notes: If the faucet you bought has no sprayer, drill holes 1 & 3 will be ok.

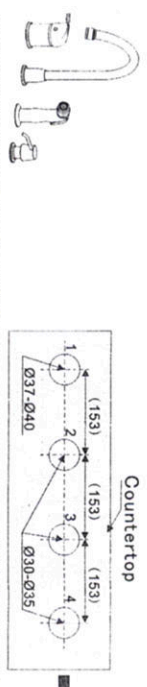

Notes: If the faucet you bought has no soap dispenser, drill holes 1, 2 & 3 will be ok. If the faucet you bought has no soap dispenser or sprayer, drill holes 1 & 2 will be ok.

1 Locating the faucet

Cut mouting holes to install the faucet. Remove the components (mounting nut and washers) which are attached to the bottom of the faucet. Install the faucet into the pre-drilled hole ensuring the washer is placed between the trim ring and the countertop surface.

Notes: Verify the dimensions against the actual faucet. If the faucet you bought has no soap dispenser or side sprayer, do not drill hole for it.

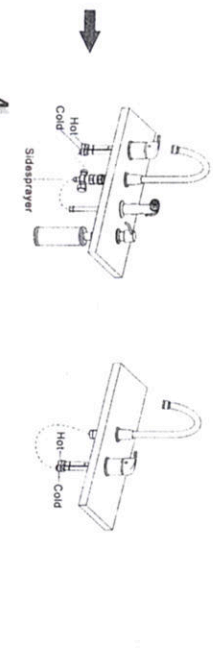
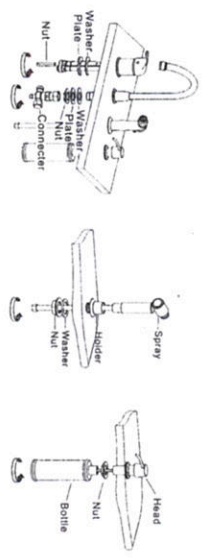
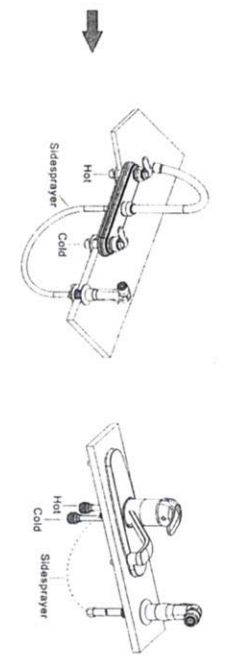
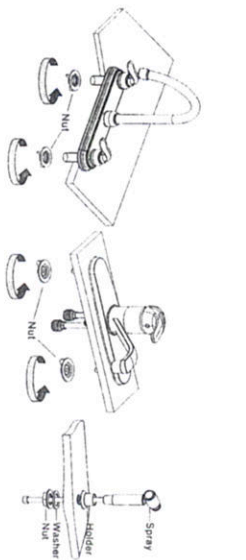
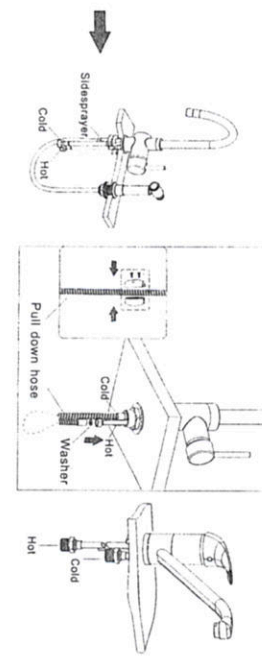
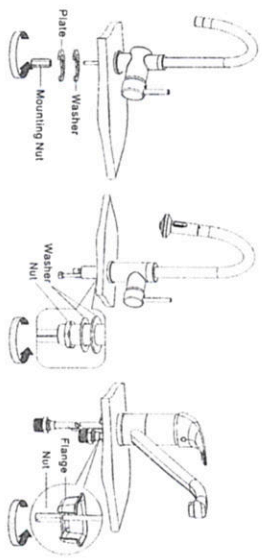

2 How to install the bottom components of the faucet

As shown above please fit the washers and mounting nut in turn, then secure the faucet to the bench by tightening the mounting nut clockwise.

If the faucet has a connector, screw to the spout shank (see wide spread kitchen faucet).

3 How to install the side sprayer and soap dispenser

Notes: If the product you bought has no spray or soap dispenser, skip it.

To install side sprayer, put holder into the hole, screw with nut. Put spray hose through holder, and fix it to the faucet. To install soap dispenser, put the head shank through hole, tighten the nut and bottle.

4 Connecting to the water supply

Connect hoses following the figure, which type is similar to the product you bought.

If the faucet you bought has sidesprayer, connect it as shown.

If the faucet you bought is pull down, Set heavy to the proper location, make sure the shower head can be pull down as you want.

After all connections are tightened up, turn on the faucet and flush through water in order to remove impurities and check for any leaks.