

# Claremont Tri-View Medicine Cabinet



## Specifications

- Solid Oak frame with Honey Oak finish
- MDF box with oak melamine sides and bottom
- Polished brass T-hinge
- Pre-assembled design
- 3 doors
- 2 fixed shelves
- California 93120 CARB P2 compliant



## Dimensions

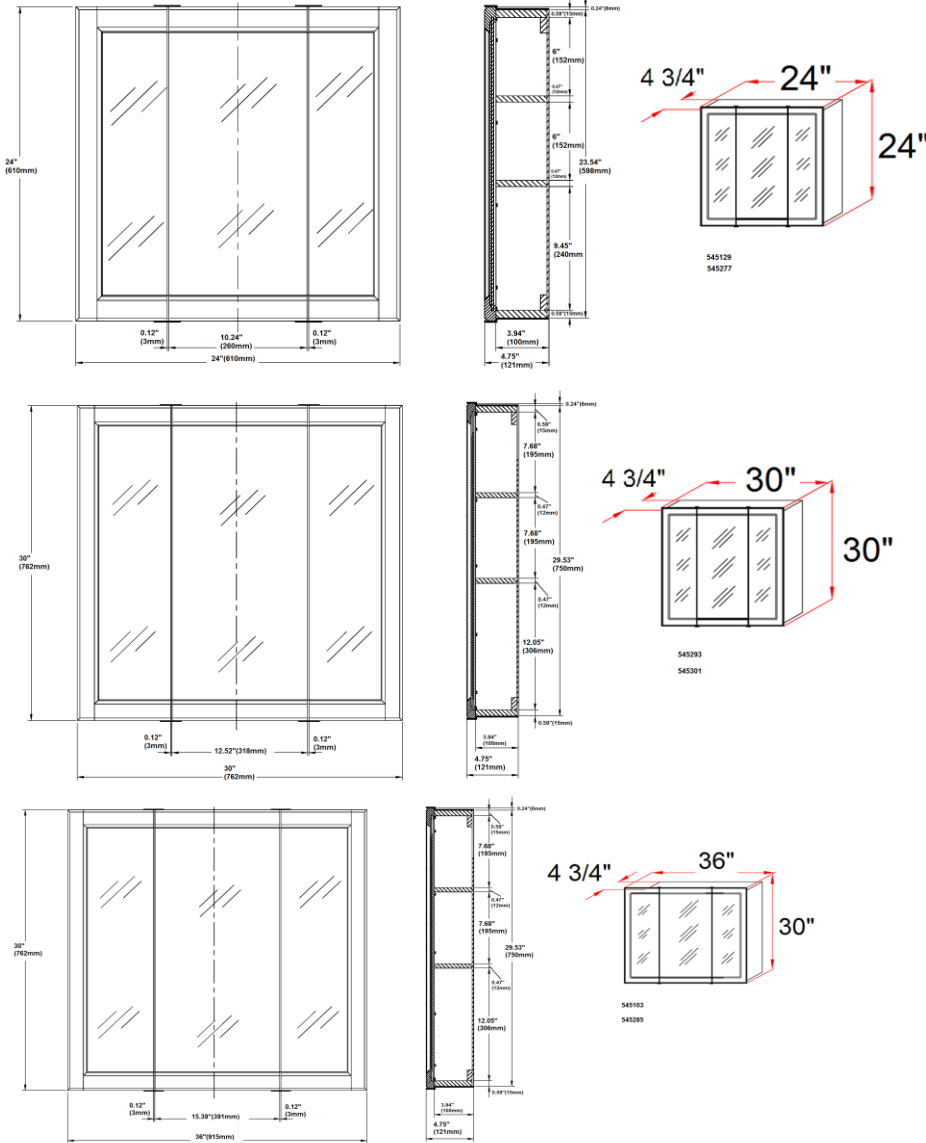

## Warranty & Compliances

- Warranty: Limited 1 year warranty
- California 93120: CARB P2 Compliant



## Order Codes & Finishes/Colors

- 24" w x 4.75" d x 24" h: 545277
- 30" w x 4.75" d x 30" h: 545301
- 36" w x 4.75" d x 30" h: 545285

Type:  
Job:  
Order Code:  
Approvals: