

# Concord Two Door Four Drawer Vanity



## Specifications

- MDF square panel doors & drawer fronts
- Full frame design
- 1/2" plywood sides
- Center mount ball bearing drawer glide system
- Concealed adjustable hinges
- Satin nickel hardware included
- Cam-lock connectors for fast & easy assembly
- Vanity top sold separately
- White Gloss Finish



## Dimensions

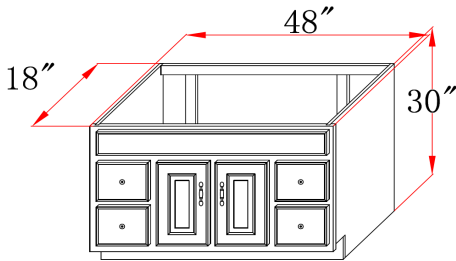

531301

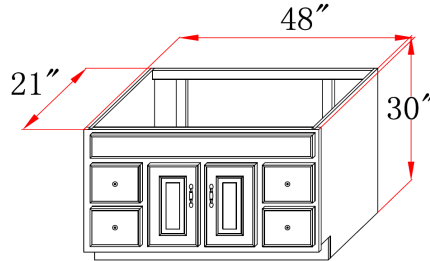

541060

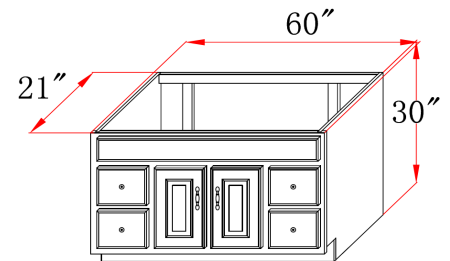

541078

## Warranty & Compliances

**Warranty** Limited 1 year warranty  
**California 93120** Compliant



## Order Codes & Finishes/Colors

48" w x 18" d x 30" h	531301
48" w x 21" d x 30" h	541060
60" w x 21" d x 30" h	541078

Type:  
Job:  
Order Code:  
Approvals:

Design House reserves the right to make changes in materials, specifications & models at any time. Design House also reserves the right to discontinue product without notice or obligation.