

**Specifications**

- Nutmeg oak finish
- Exposed hinges
- Pre-assembled design
- 3 Doors
- 2 Shelves
- Solid oak frame
- Durable water resistant finish

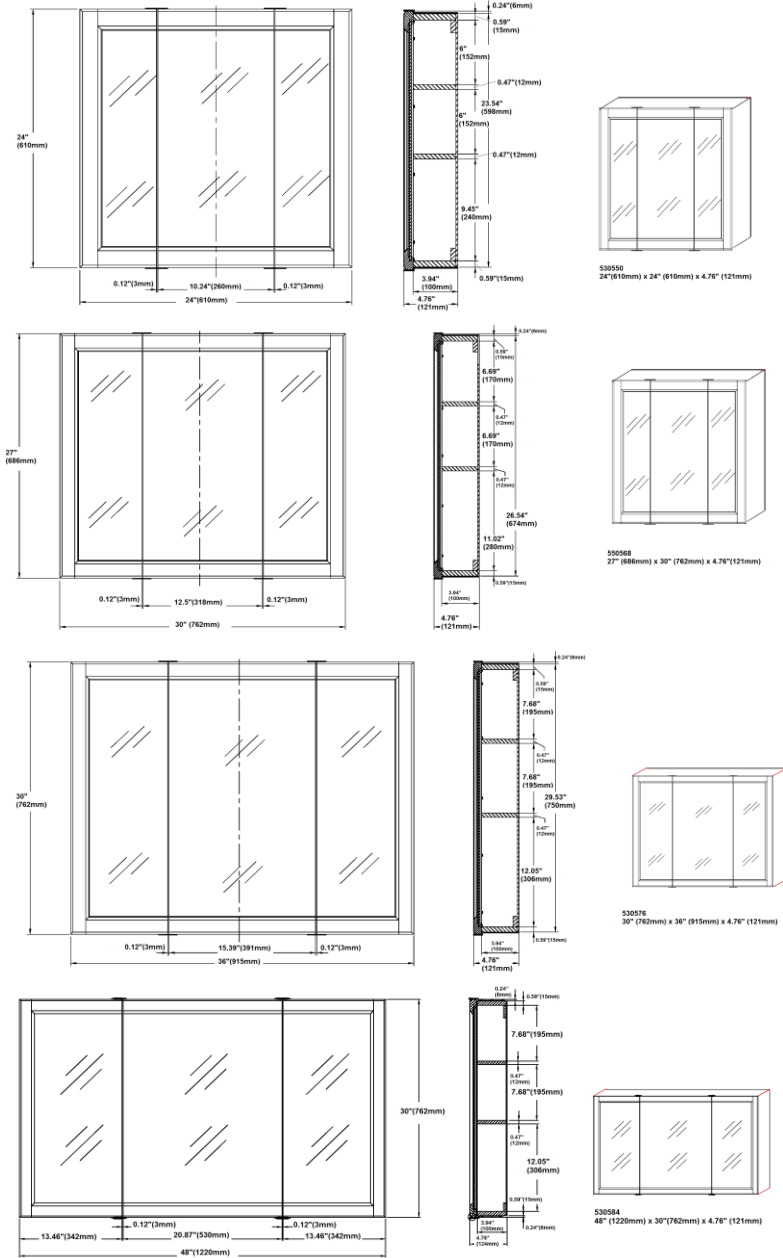

**Dimensions**



**Warranty & Compliances**

Warranty: Limited 1 year warranty  
 California 93120: Compliant



**Order Codes & Finishes/Colors**

24" w x 5" d x 24" h	530550
30" w x 5" d x 27" h	530568
36" w x 5" d x 30" h	530576
48" w x 5" d x 30" h	530584

Type:  
 Job:  
 Order Code:  
 Approvals: