

PRESCOTT LED DISK LIGHT (ITEM#578443/578450) ASSEMBLY & INSTALLATION INSTRUCTIONS

Safety Information

Read all instructions before installation.

This device complies with part 15 of the FCC Rules and has been tested and found to comply with the limits for a Class B digital device. These limits are designed to provide reasonable protection against harmful interference in residential installations. This equipment generates, uses, and can radiate radio frequency energy and, if not installed and used accordance with the instructions, may cause harmful interference to radio communications.

Package Contents

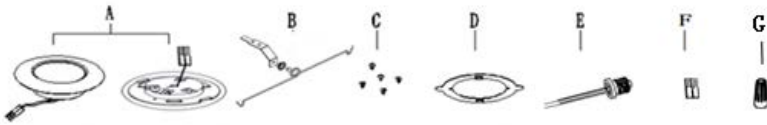

Part	Description	Qty
A	6in. or 4in. Disk light	1
B	Clips	2
C	Screw	4
D	Bracket	1
E	E26 Base adaptor	1
F	Female connector	1
G	Wire nuts	1

BEFORE INSTALLATION

To prepare for a junction box installation, refer to the information below to determine if the disk light mounting bracket (D) is required:

Junction Box Type ¹	4 in. Light ²	6 in. Light ²
Square ³	Install bracket ⁴	Install Bracket ⁴
Octagonal ³	Install bracket ⁴	Install Bracket ⁴
Round ³	Install Bracket ⁴	Install Bracket ⁴

TOOLS REQUIRED

Phillips screwdriver



Recessed Housing/Retrofit Installation

1. Remove existing trim and lamp from housing. If housing contains a socket bracket, remove socket bracket and prepare electrical leads for connection. Note: if optional adapter will be used, leave socket bracket in place.

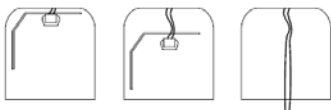

2. Attach the clips (B) to the disk (A) using screws (C); provided.



WARNING: In compliance with CA Proposition 65, note that this product contains a chemical known to the state of California to cause cancer, birth defects, or other reproductive harm.

WARNING: Risk of Electric Shock. Disconnect power at the fuse or circuit breaker before installing or servicing.

WARNING: Not intended for use with emergency exit fixtures or emergency exit lights. Not for use where exposed directly to the weather or water. Not for use in totally enclosed recessed fixtures.

WARNING: Risk of Fire or Electric Shock. Installation of this product requires knowledge of luminaire electrical systems. If not qualified, do not attempt installation. Contact a qualified electrician.

WARNING: Risk of Fire or Electric Shock. Installation this product only in the applications that have the construction features and dimensions shown in the photographs and/or drawings.

DO NOT make or alter any open holes in an enclosure of wiring or electrical components during kit installation.

WARNING: To prevent wiring damage or abrasion, do not expose wiring to edges of sheet metal or other sharp objects.

CAUTION: Any changes or modifications not expressly approved by the party responsible for compliance could void the user's authority to operate the equipments.

CAUTION: Risk of electrical shock. Do not open, there are no user serviceable parts inside. Turn the power off before inspection, installation, or removal. The lamp is suitable for use in damp locations. Use only on 120 VAC, 60Hz circuits.

Electrical Ratings

MODEL	Input Volts (Vac)	Input Frequency (Hz)	Input Watts (W)
6INCH LED SURFACE MOUNT 3000K	120	60	14.1

3. Connect the orange female connector (F) from the disk light to the orange male connector that extends from the end of the socket base adaptor (E).

Note: for retrofit housing installations, the ground wire should be capped with wire nut (G).

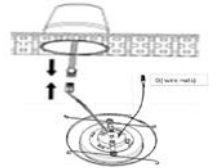

4. Screw the socket base adaptor (E) into the existing medium base socket on the recessed housing.



5. Squeeze the V-clips (B) on the back of the disk light and push into open slots on the inside of the recessed housing. Push the disk light upward until flush with the ceiling surface. Note: For wet location applications, apply caulk between ceiling and disk light module.



Junction Box Installation

1. Install the mounting bracket (D) onto the junction box using the screws (C); provided.

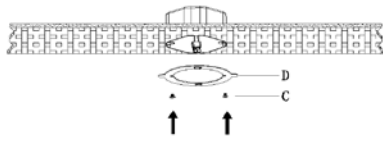

2. Make wiring connections:

A) Connect the black junction box wire (hot wire) to the black fixture wire using one of the provided wire nuts (G).

B) Connect the white junction box wire (neutral wire) to the white fixture wire using one of the provided wire nuts (G).

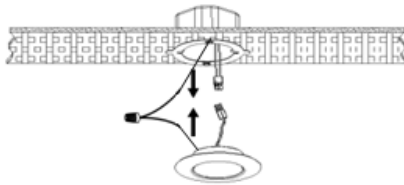

3. Attach fixture ground wire (factory installed on module) to junction box per national and local electrical code.

Note: Ground wire must be securely attached to junction box



4. Push the disk light upward until flush with the ceiling surface. Slide the black fixture mounting bracket over the metal mounting bracket (D); rotate clockwise until disk light is securely tightened to the mounting bracket (D).

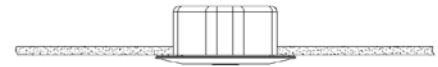
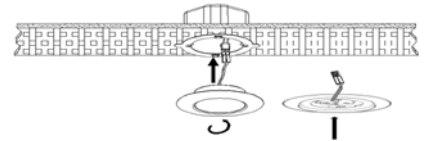

**IF IN DOUBT ABOUT ELECTRICAL INSTALLATION,
CONSULT A LICENSED ELECTRICIAN.**

Customer Service: 1-800-558-8700