

540815

# ASSEMBLY INSTRUCTIONS

DHI Corp. • 5205 W. Donges Bay Rd. • Mequon, WI 53092 • 800.558.8700

# PARTS LIST:

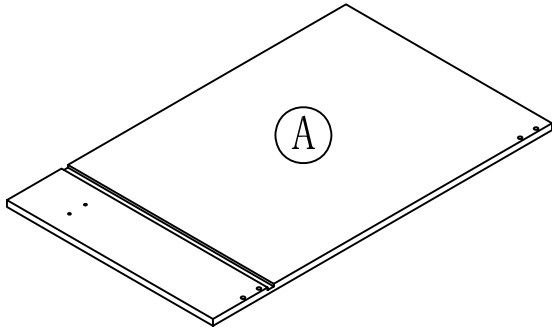

LEFT SIDE PANEL 1PC

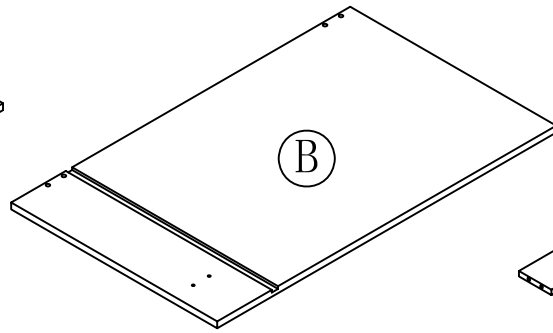

RIGHT SIDE PANEL 1PC

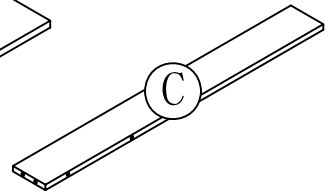

BACK UP CROSS  
BRACE 1PC

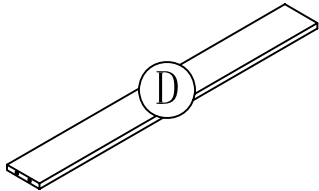

BACK DOWN CROSS  
BRACE 1PC

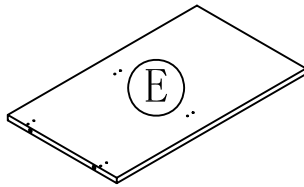

BACK PARTITION  
PANEL 1PC

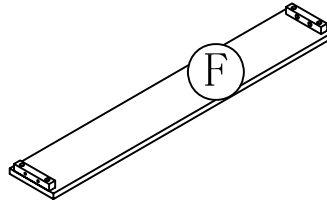

TOE KICK PANEL 1PC

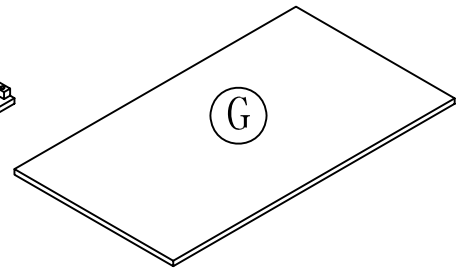

BOTTOM PANEL 1PC

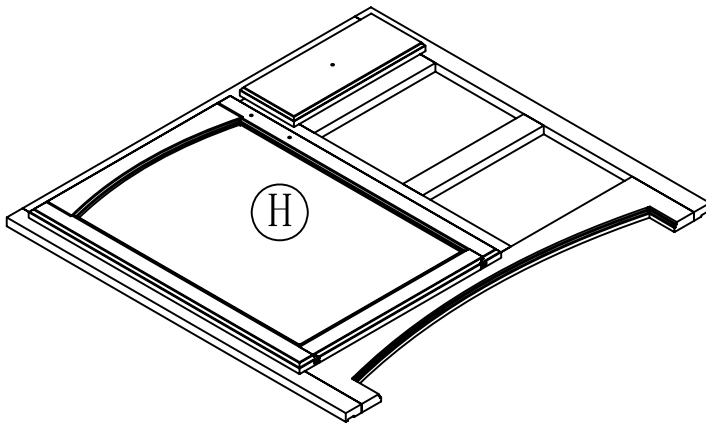

FRONT FRAME 1PC

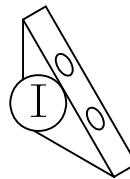

STRENGTH BLOCK 8PCS

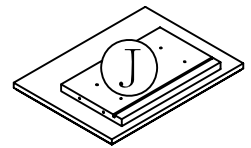

DRAWER FRONT  
PANEL 2PCS

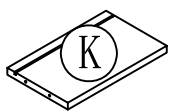

DRAWER BACK  
PANEL 2PCS

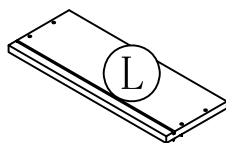

DRAWER LEFT SIDE  
PANEL 2PCS

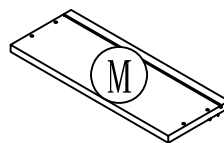

DRAWER RIGHT SIDE  
PANEL 2PCS

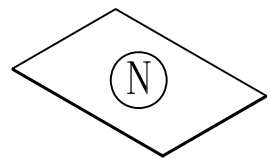

DRAWER BOTTOM  
PANEL 2PCS

# HARDWARE LIST:



a. WOOD DOWEL 12PCS



d. 1" L FLAT HEAD  
SCREW 20PCS



e. 1-1/2" L FLAT HEAD  
SCREW 16PCS

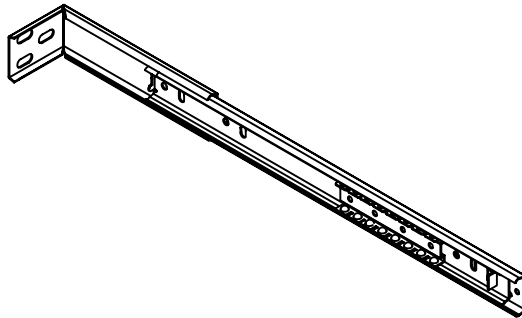

i. DRAWER GUIDE 4PCS

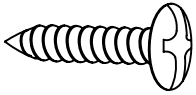

g. 1/2" ROUND HEAD  
SCREW 16PCS

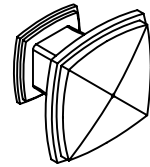

l. KNOB 3PCS

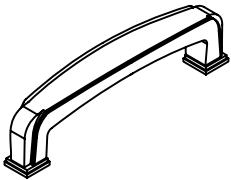

m. HANDLE 1PC

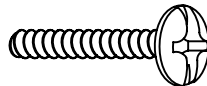

n. HANDLE (KNOB)  
BOLT 5PCS

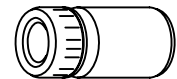

p. GLUE 1PC

# STEP 1

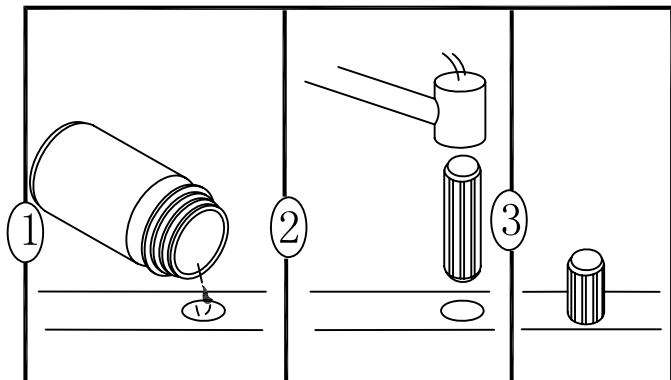
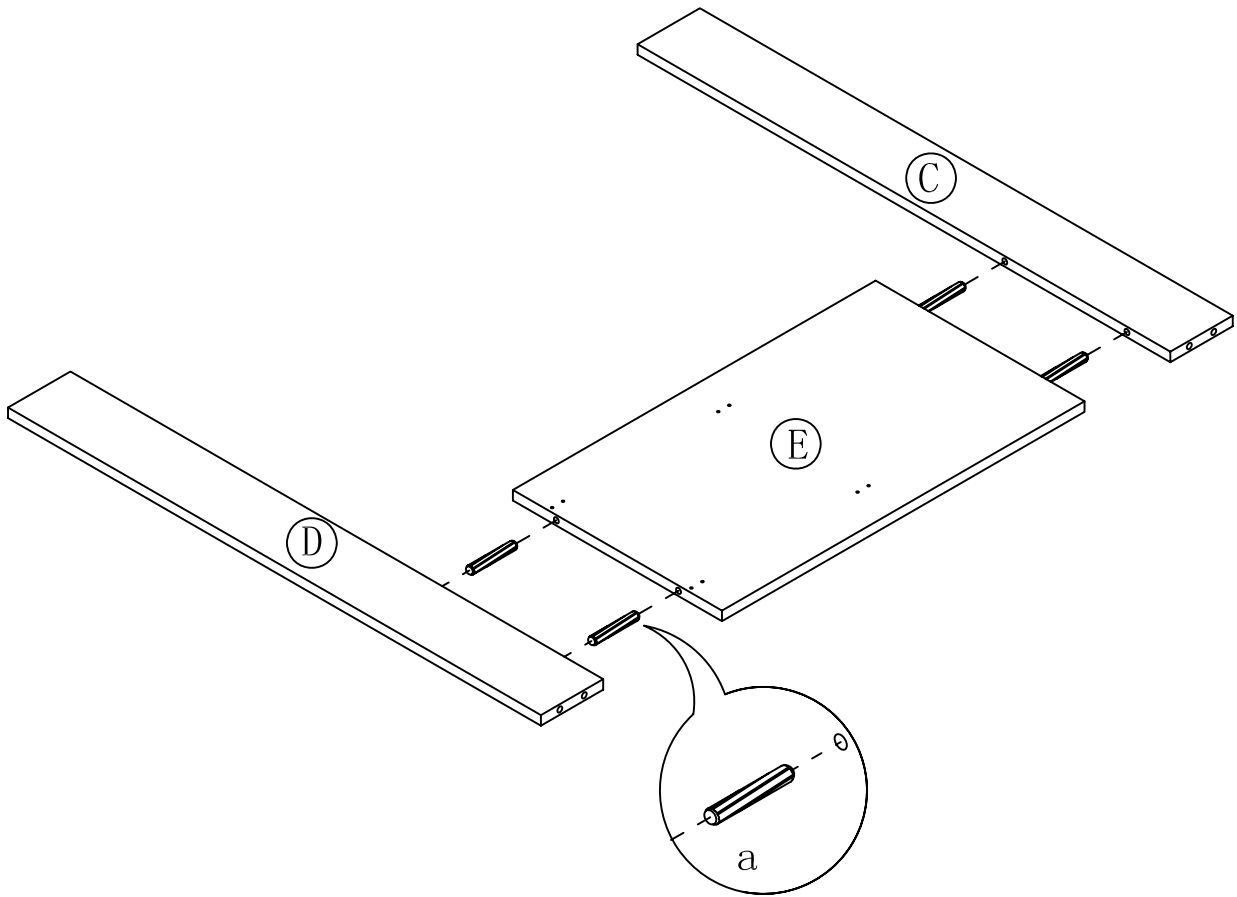

# STEP 2

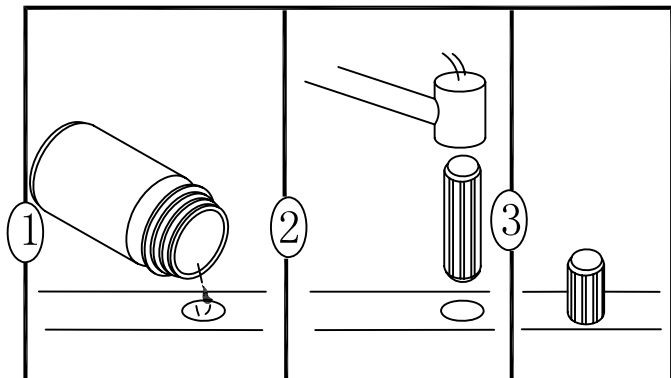
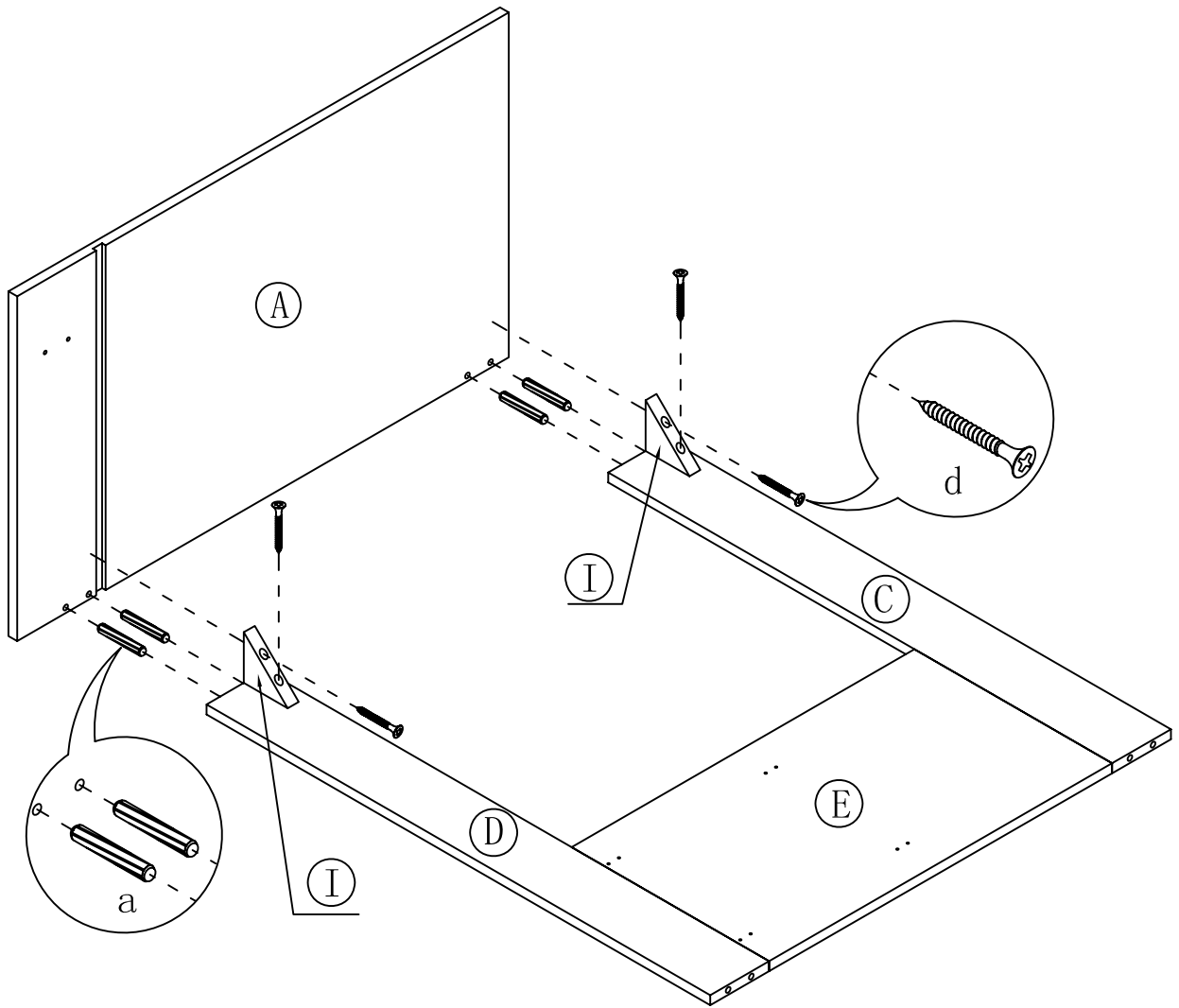

# STEP 3

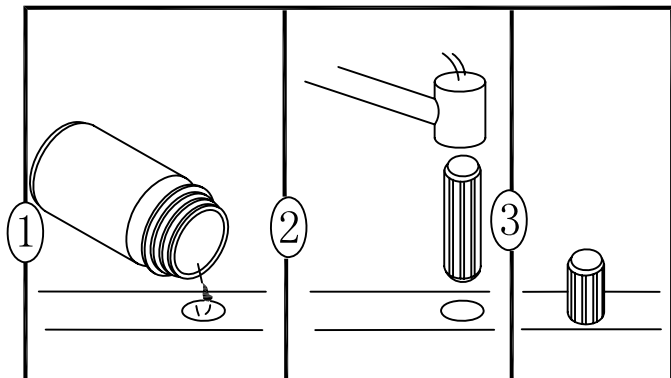
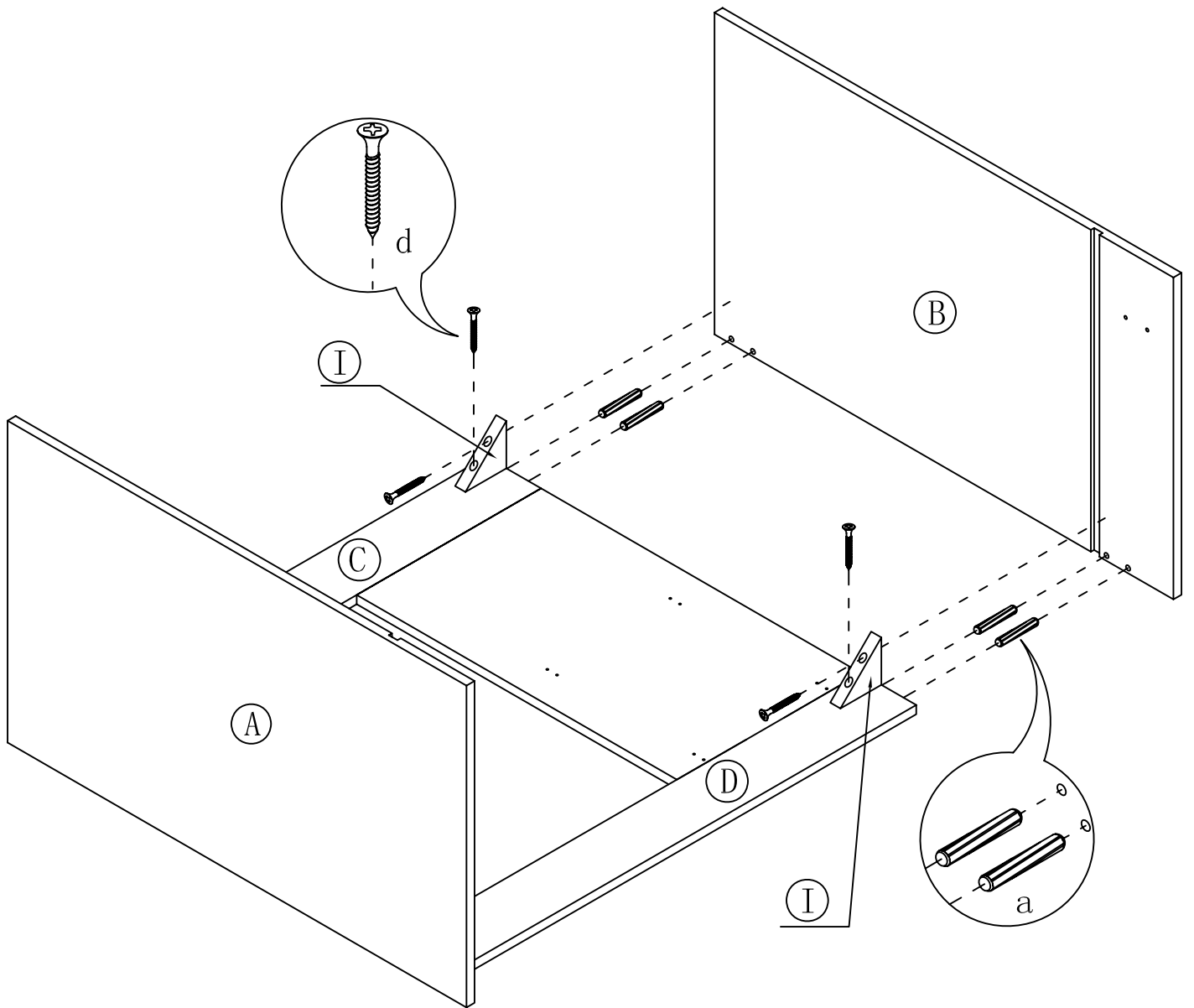

STEP 4

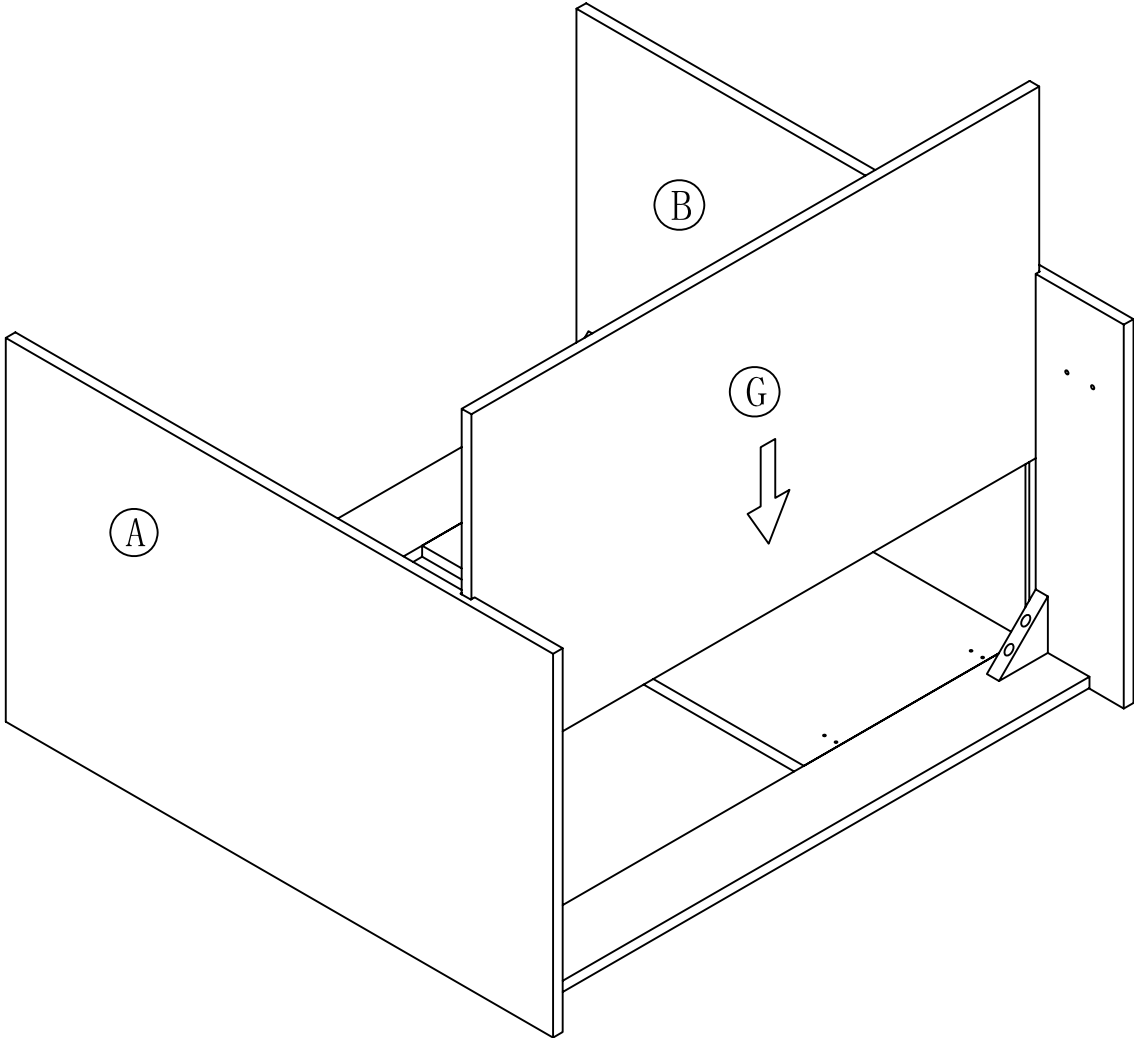

# STEP 5

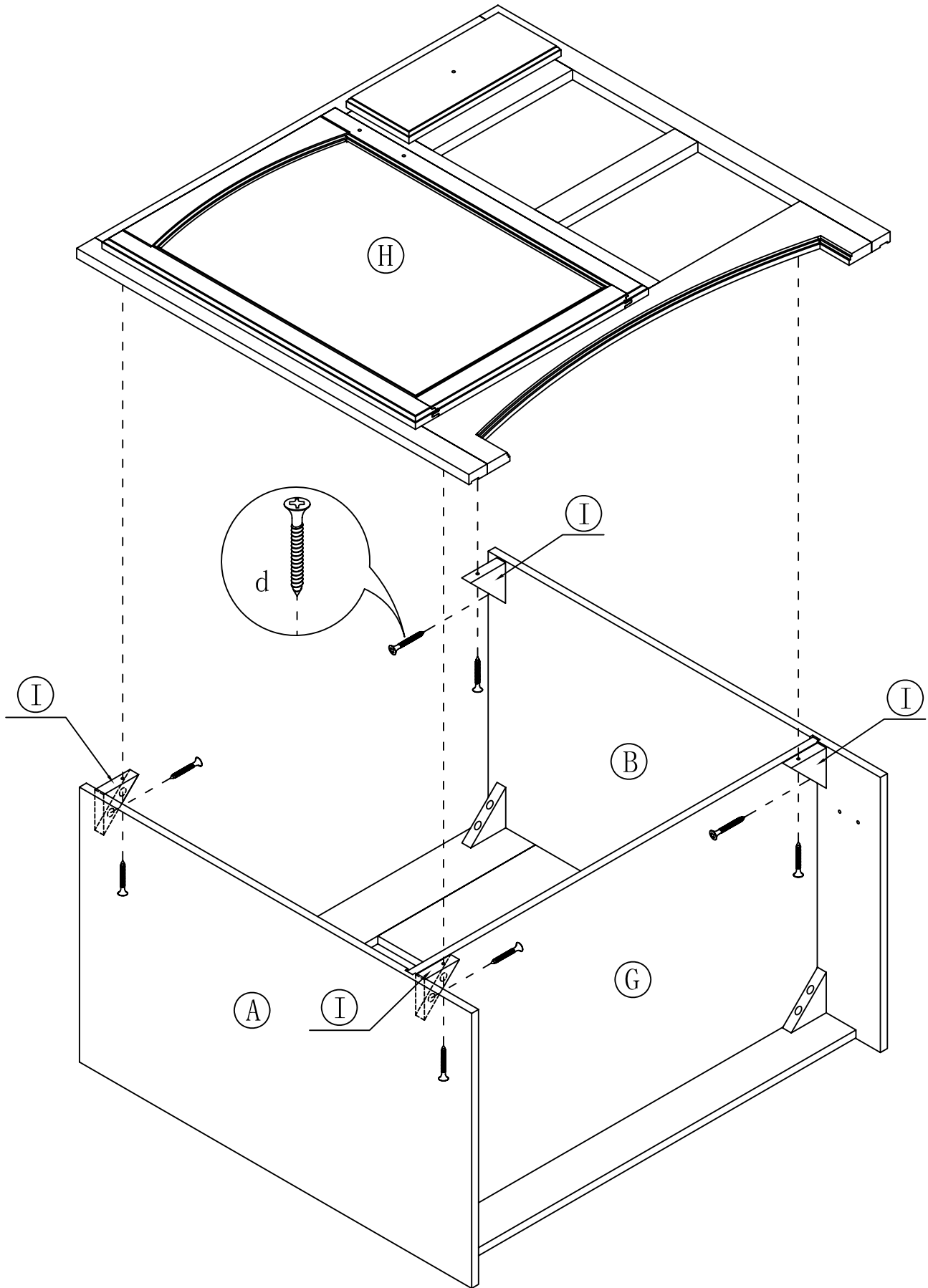



# STEP 6

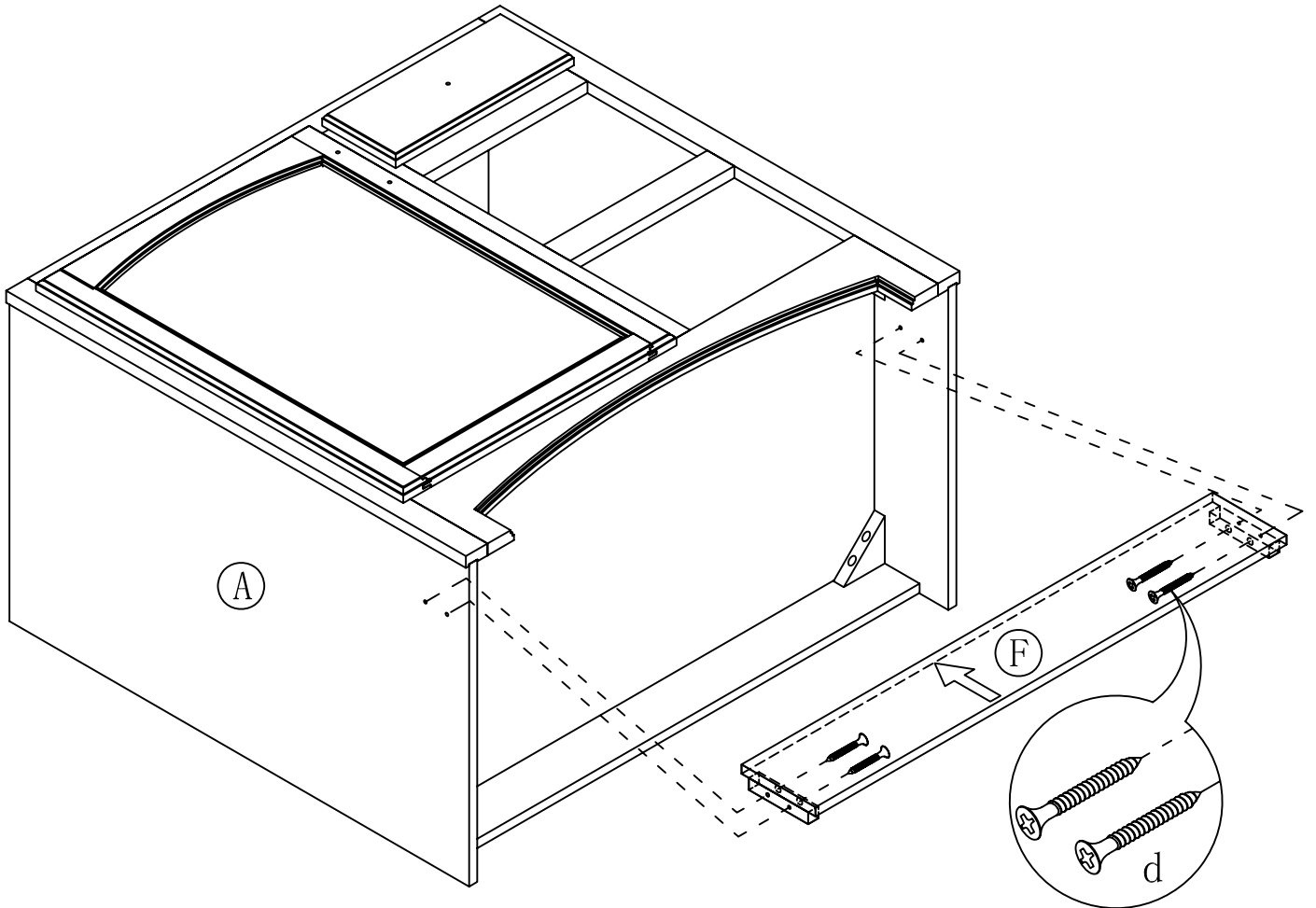

# STEP 7

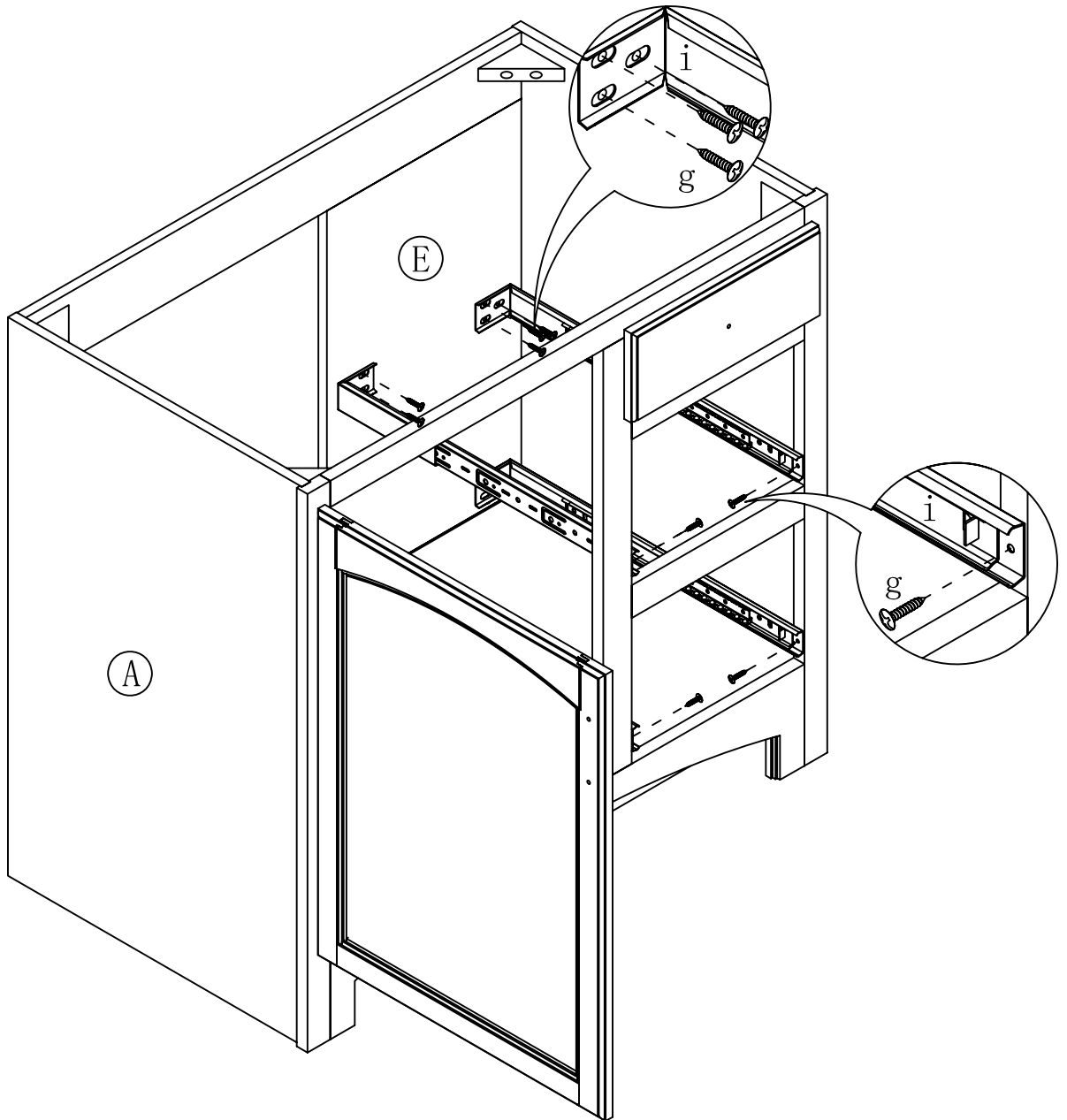



# STEP 9

